

*Nestled amongst
the tall evergreens
of Redmond...*

Overlake Terrace takes advantage of its suburban surroundings. Our accessible yet scenic location makes our community a wonderful place to call home.

Overlake Terrace

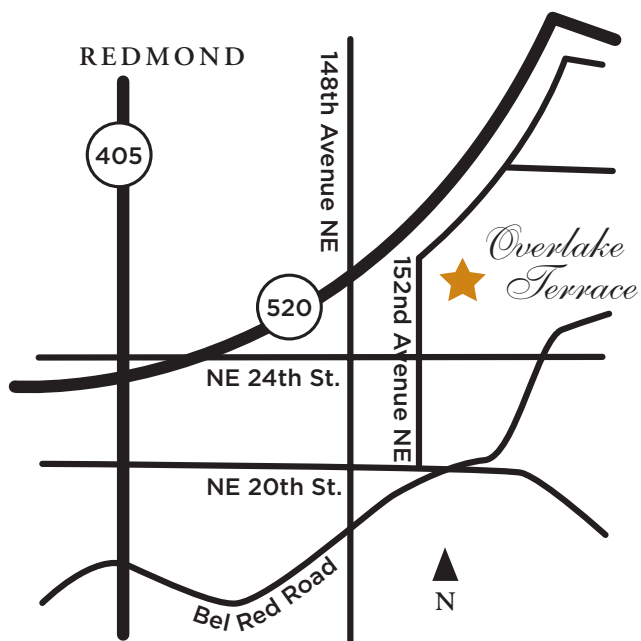

KINGSWOOD COURT • MEMORY CARE

Overlake Terrace

INDEPENDENT • ASSISTED LIVING • MEMORY CARE

2956 152nd Avenue NE • Redmond, Washington 98052

☎ 425.883.0495 • ☎ 425.881.5118

www.overlaketerrace.com



Overlake Terrace

"People Who Care...Caring for People"™



Kingswood Court

Kingswood Court is a secure memory care community designed to create a successful and supportive environment for individuals suffering from all forms of dementia. The staff in Kingswood Court are specially trained to provide our residents with compassionate care in a dignified and comfortable, yet safe and secure, home-like environment.

We also offer...

Respite • Short Term Stays & Day Care Services

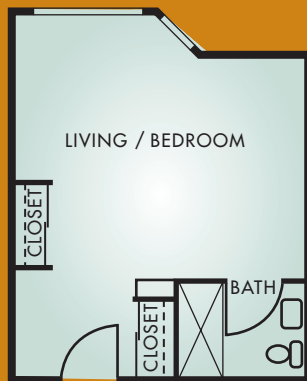

PRIVATE STUDIO • 330 SQUARE FEET

Memory Care and Life Enrichment

In Kingswood Court the experts have thought of everything...

The community features a circular floor plan to enable our residents and allow them the independence to walk and wander safely. Our secure outdoor courtyard provides residents with a greater sense of freedom and has way-finding paths to help orient them.

Kingswood Court also features neighborhood murals, presenting visual cues to stimulate memory. Each mural creates interactive memory and reminiscence opportunities to help our residents remember familiar daily activities such as shopping at the grocery, hardware or fabric stores or going to the post office or movie theater.

We understand that each resident is unique, which is why a specialized service plan is designed and tailored to meet your loved one's individual needs.



SHARED APARTMENT • 415 SQUARE FEET